

# AIR-OPERATED WASTE OIL DRAIN MANUAL

## RQN1063

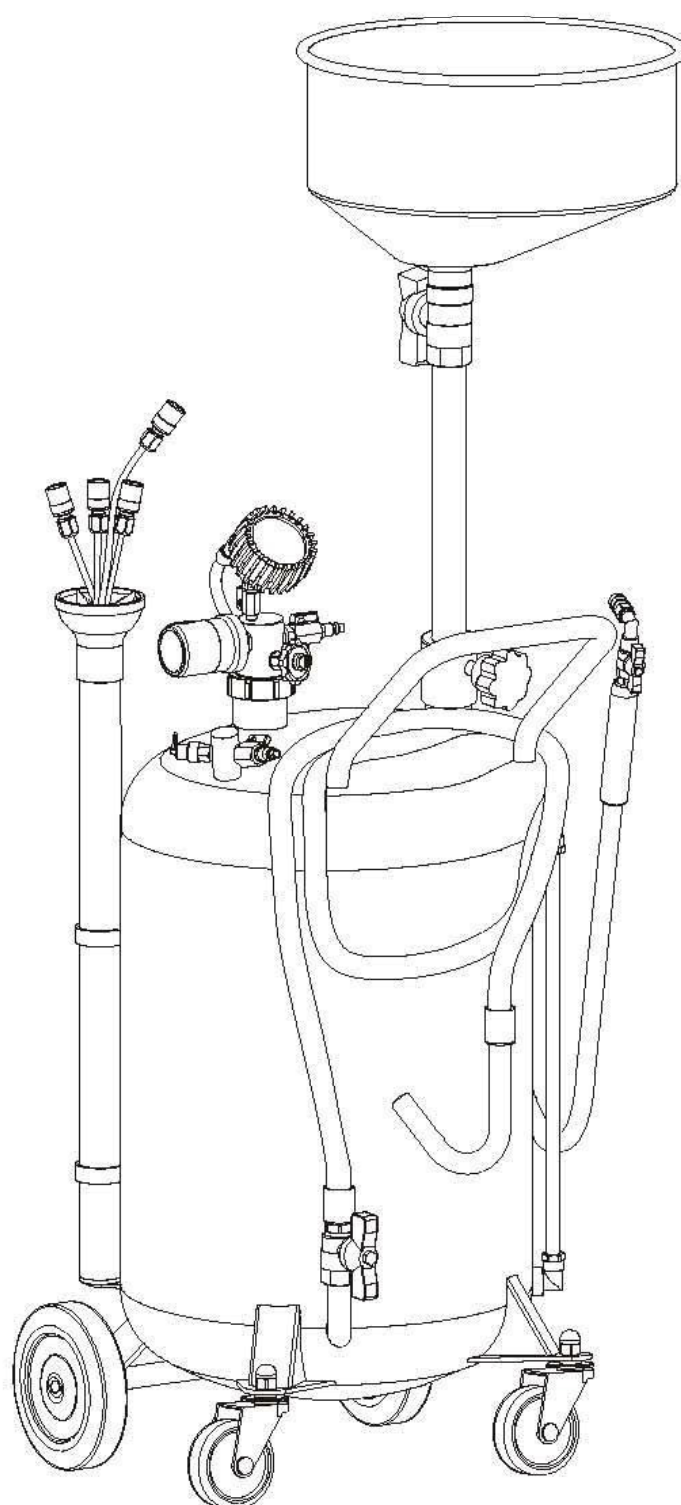

## **WARNING**

- For waste oil use only.
- Do not expose the reservoir to any source of heat.
- While extracting high temperature oils, keep hands and face protected.
- Only use the device for the purpose for which it has been designed.
- Do not modify any component of the equipment.
- Only use original spare parts.
- Contract American lubrication if you need any additional information.

## **ATTENTION**

- Some cars have a built-in oil suction probe.
- In this case, connect the coupler of the oil changer B directly to the probe.
- For other makes of car (Volkswagen-BMW) equipped with a built-in probe having a different opening, connector(C-Volkswagen, D-BMW) must be used.

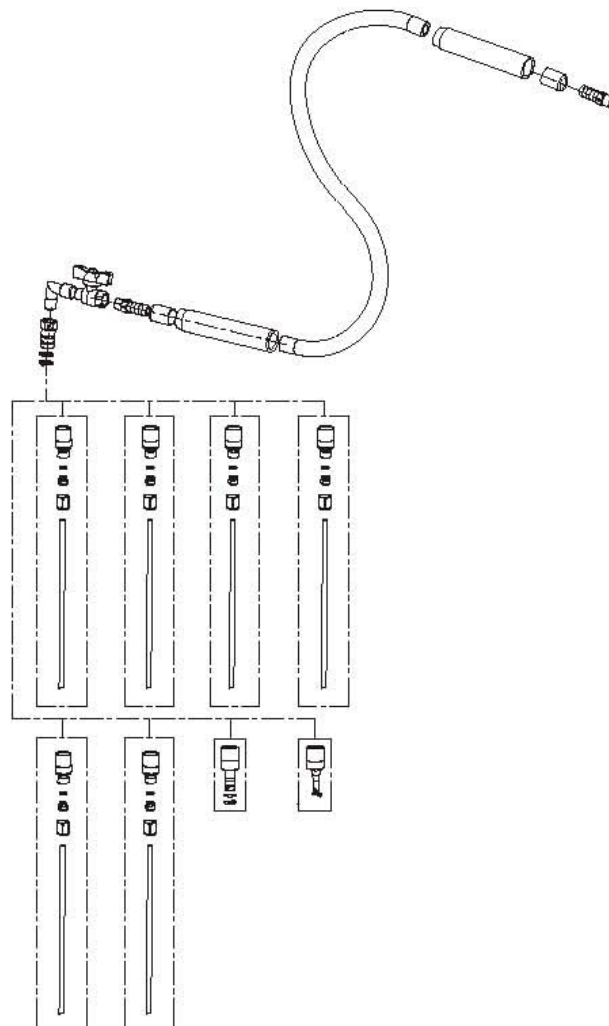

## ASSEMBLY

**Fig.1:** Attach the venture group to the tank. Make sure the gasket is properly positioned. Tighten the ring nut J using a suitable wrench.

**Fig.2:** Connect the drain hose with the ball valve and adapter I on the base of the units tank.

**Fig.3:** Connect the basin P to the ball valve Q. Then insert the whole group in the reservoir support and tighten screw with handwheel M by turning it clockwise. Secure the hose with the hose clamp provided.

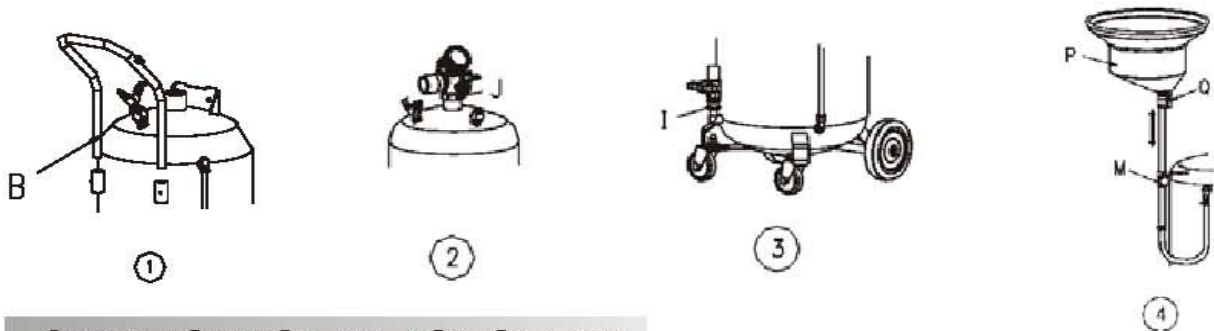

## CHARGING THE SYSTEM

### DRAINER

**Fig.5:** Close the ball valve B.

Position the oil drainer under a car located on a lift and drain the waste oil.

### SUCTION

**Fig.6:** Open completely the valve K by turning it counter clockwise. Close the suction valve (ball valve) A. Close the air valve (ball valve) L. Close the drain valve (ball valve) B.

**Fig.7:** Connect compressed air 100psi (7bar) to quick couple D, Open the ball valve C and valve F. Air will flow out from the muffler E. When the arrow of the vacuum gauge approaches the red field, after 2.5-3min, close the ball valve C, then shut-off the compressed air. The unit is now depressurized and ready for use.

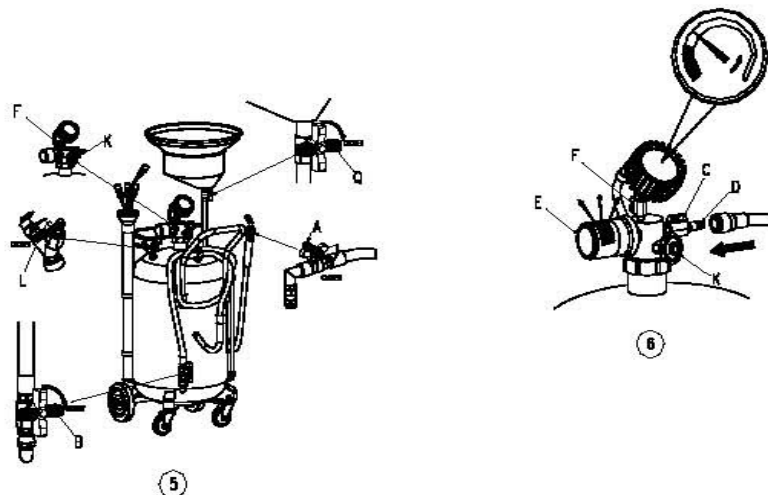

## OPERATION

- Oil should always be removed when they are hot (70-80°C). The suction capacity of the unit is equal to 2/3 of its reservoir capacity.
- With the engine still warm, remove the dipstick and insert the largest possible probe as far down as it will go.
- Connect the suction hose to the probe. Open ball valve C, keeping the probe dipped in the oil. As soon as the sump is emptied, close ball valve C. It is also possible to suck hot waste oil while keeping the air connected to the device.

## EMPTING

### IMPORTANT!! (Fig.7)

- Make sure that valve K and F is closed.
- Made sure that valve Q is closed.
- Open the valve B.
- Connect compressed air (7 psi-0,5Bar) to quick couple M , open the ball valve F until all fluids have been transferred from the unit's storage tank.
- The unit storage tank has been equipped with a safety valve calibrated at 14 PSI-1BAR.

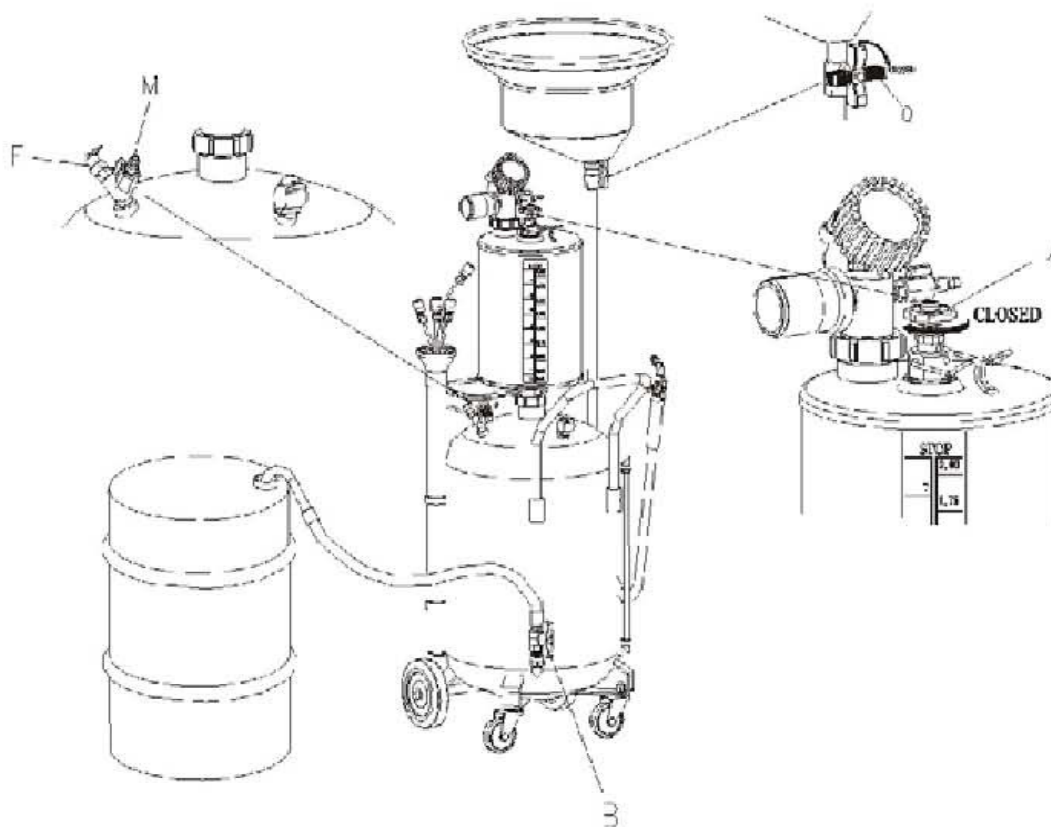



## CAUTION

Never fill the reservoir over the maximum level indicated by the gauge that is located on the side of the reservoir.

### EMPTYING IMPORTANT!

**Fig.6:** Make sure that valve C is closed .

Make sure that screw E is tightened.

Attach the end of the drain hose to a suitable waste oil container.

Open ball valve G.

Connect compressed air (7psi/0.5 Bar) to quick couple M.

After the fluids have been transferred from the unit's reservoir tank close ball valve G.

The unit is equipped with a safety valve that has been factory calibrated at 1 bar (14 PSI).

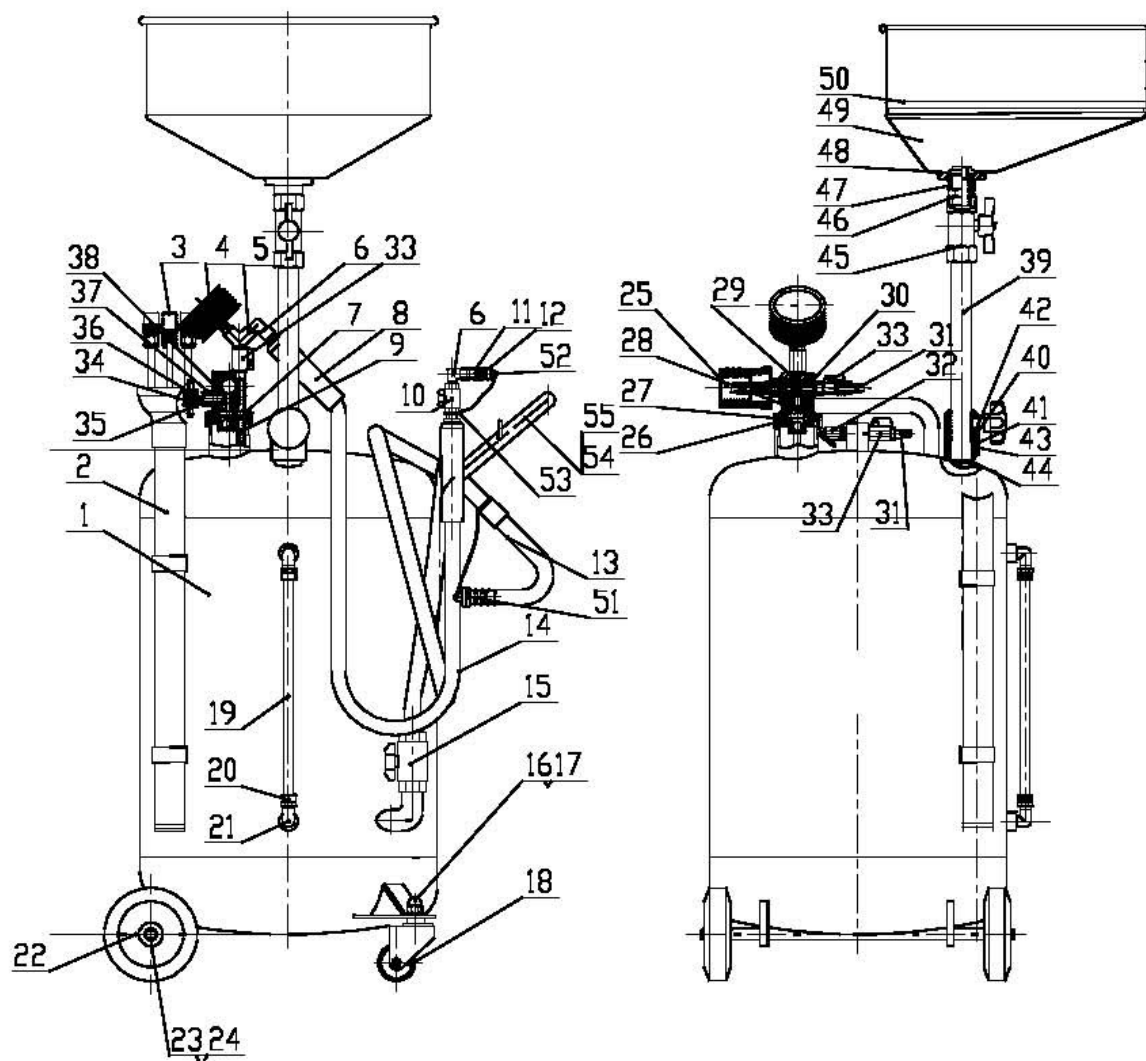

# PARTS LIST OF RQN1063

No.	Code	Description	Q.ty
1	U2308083	WHEELS	2
2	U2308060	RESERVOIR 90L	1
3	U2308075	SWEVELLING WHEELS	2
4	U2308047	PLAIN WASHER	2
5	U2308001	ACORN NUT	2
6	U2308020	ELBOW	2
7	U2308061	RING	2
8	U2308078	TUBE WITH LABEL	1
9	U2308019	DOUBLE END ADAPTER	1
10	U2308004	BALL VALVE	1
11	U2308018	DISCHARGING HOSE	1
12	U2308011	CHAIN	1
13	U2308046	PAN HEAD SCREW	1
14	U2308073	STUFF	1
15	U2308038	O-RING 16X2.4	2
16	U2308067	SCREW WITH CHAMFERED END	2
17	U2308065	SCREW	1
18	U2308070	SET OF SCREWS FOR RESERVOIR	1
19	U2308027	HANDLE	1
20	U2308081	VALVE BADY	1
21	U2308037	O-RING 15X2.65	1
22	U2308045	O-RING 9.5X2.65	1
23	U2308072	STEEL BALL	1
24	U2308071	SPRING LOCK WASHER	1
25	U2308068	SCREW WITH CHAMFERED END	1
26	U2308041	O-RING 42.5X2.65	1
27	U2308082	VITTA	1
28	U2308048	PLUGS	1
29	U2308034	O-RING 10X1.8	1
30	U2308005	BALL VALVE	1
31	U2308032	MUZZLE	1
32	U2308079	VACUUMETER	1
33	U2308058	PROTECT SET	1
34	U2308084	Y-ELBOW ADAPTER	1
35	U2308021	ELBOW ADAPTER	1
36	U2308063	ROUND NUT WITH COLLAR	1
37	U2308069	SEAT	1
38	U2308080	VALVE	1
39	U2308013	COMPLETE MUFFLER	1
40	U2308040	O-RING 4.47X1.78	1
41	U2308042	O-RING 5.28X1.78	1
42	U2308002	ADJUSTING SCREW	1
43	U2308030	HEXAGON NUT	1
44	U2308028	HANDWHEEL	1
45	U2308077	TOOL TRAY	1
46	U2308057	PROBES CONTAINER	1
47	U2308049	PLUGS	1
48	U2308006	BALL VALVE	1

No.	Code	Description	Q.ty
49	U2308076	T-ELBOW ADAPTER	1
50	U2308064	SAFETY VALVE	1
51	U2308014	COMPLETE SUCTION HOSE	1
52	U2308059	PROTECT SET	2
53	U2308012	CHAIN	1
54	U2308050	POTHOOK	1
55	U2308007	BALL VALVE	1
56	U2308022	ELBOW ADAPTER	1
57	U2308031	LINKER	1
58	U2308036	O-RING 13.2X1.8	2
59	U2308074	STUFF	1
60	U2308044	O-RING 7.5X1.8	2
61	U2308051	PROBE $\phi$ 5X700 FLEXIBLE	1
62	U2308053	PROBE $\phi$ 6X700 FLEXIBLE	1
63	U2308055	PROBE $\phi$ 7X1000 FLEXIBLE	1
64	U2308056	PROBE $\phi$ 8X700 FLEXIBLE	1
65	U2308052	PROBE $\phi$ 5X700 MALLEABLE	1
66	U2308054	PROBE $\phi$ 6X700 MALLEABLE	1
67	U2308017	CONNECTOR(VOLKSWAGEN)	1
68	U2308035	O-RING 10X1.8	2
69	U2308016	CONNECTOR(BMW)	1
70	U2308043	O-RING 6.7X1.8	1
71	U2308024	FILTRATING PLANK	1
72	U2308033	OIL COLLECTING BOWL	1
73	U2308008	BALL VALVE	1
74	U2308003	ADJUSTING STEEL TUBE	1
75	U2308023	ELBOW ADAPTER	1
76	U2308015	CONNECTING HOSE	1
77	U2308029	HANDWHEEL	1
78	U2308025	FIXURE SET	1
79	U2308010	BOWL SUPPORTING TUBE	1
80	U2308039	O-RING 28X2.65	2
81	U2308062	ROTOR	1
82	U2308066	SCREW	1
83	U2308026	FUNNEL EXTENSIONER	1
84	U2308009	BOLT	2

